

ACT20P-AI-AO-S

## Isolator Manual

Model Type: ACT20P-AI-AO-S

Order Number: 7760054130



### Caution

- Please check the product type model and the specification on the product outside wrapping in order to ensure they are accord with the purchase contract.
- Carefully read and understand this manual before using this product. Any question, please contact our company technical support hotline for assistance.
- Isolator should be installed in proper area.
- Power supply is 24VDC, 220VAC is strictly forbidden.
- Do not allowed repair the products by the customer.

### ■ Specification

|                            |   |
|----------------------------|---|
| Channel:                   | 1   |
| Input:                     |   |
| Input signal:              | Current source/Voltage source   |
| Current range:             | 4~20mA/0~20mA/0~10V/0~5V/1~5V/2~10V   |
| Input impedance:           | $\leq 100\ \Omega$ (4~20mA/0~20mA)<br>$\geq 100k\ \Omega$ (0~10V/0~5V/1~5V/2~10V) |
| Maximum voltage:           | 30V   |
| Maximum current:           | 36mA  |
| Output:                    |   |
| Current range:             | 4~20mA/0~20mA/0~10V/0~5V/1~5V/2~10V   |
| Output load:               | $\leq 550\ \Omega$ (4~20mA/0~20mA)<br>$\geq 2k\ \Omega$ (0~10V/0~5V/1~5V/2~10V)   |
| Accuracy:                  | 0.1%F.S.  |
| Temperature coefficient:   | 100ppm/K  |
| Response time:             | $\leq 100ms$  |
| Power supply:              |   |
| Supply voltage:            | 18~31.2V,d.c.   |
| Power protection:          | Inverse protection  |
| Insulation coordination:   |   |
| Standards:                 | EN61010-1,UL61010-1   |
| EMC standards:             | IEC61000-6-2,IEC61000-6-4   |
| Rated voltage:             | 300V  |
| Impulse withstand voltage: | 4000V(1.2/50 $\mu s$ )  |
| Isolation voltage:         | 2000V   |
| Overvoltage category:      | III   |
| Pollution severity:        | 2   |

### ■ General

The surrounding air should not include the material which can corrupt the coating of chrome,nickel. And the installation cabinet should not subsist electromagnetism induction influence,such as violent quiver or impact,big current spark and so on.

Operating temperature: -20℃ to+60℃  
Storage temperature: -40℃ to+85℃  
Relative humidity: 5% to 95%RH  
Housing: CH20M housing  
Weight: approx.105g

### ■ Wiring

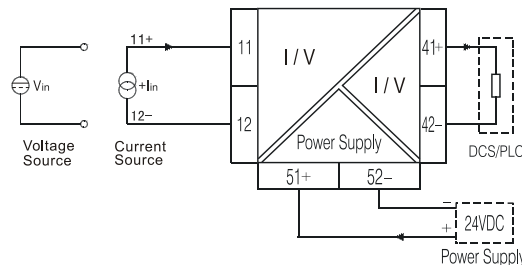

### ■ Dimensions

HeightXLengthXWidth: 117X114X12.5(mm)

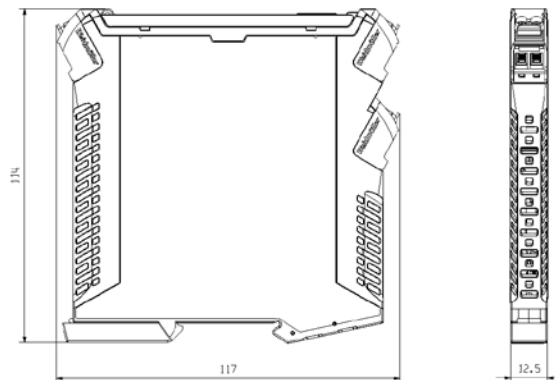

### ■ Front cover and terminal definition



### ■ Installation

The product is designed to be mounted onto a TS 35 DIN rail. It clips onto the rail via a spring-loaded mounting foot and can be removed via a spring release on the edge of the product near the mounting rail.

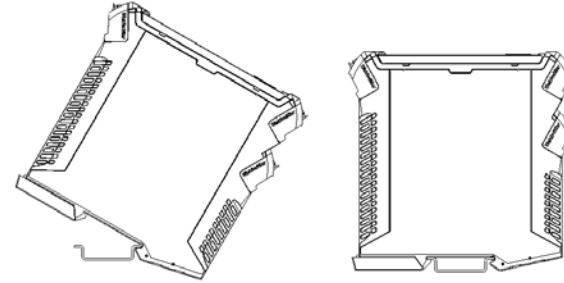

### ■ Uninstallation

Please refer to the following picture when try to uninstall the isolator from the Din rail. Insert the screw driver into the hold of the house feet and turn the screw drive to take off the isolator.

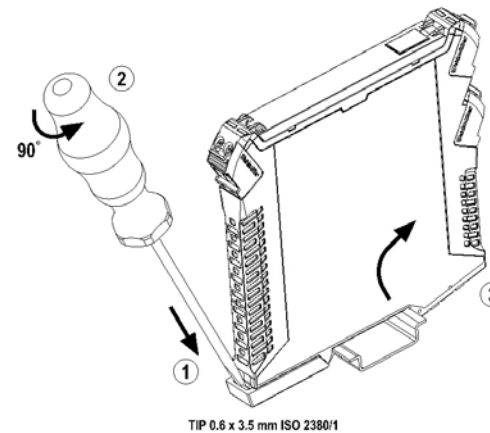

### ■ Marker

A device marker is located below the upper set of terminals for costumer identification.

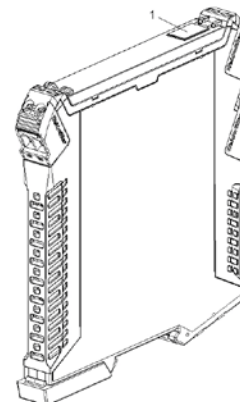

### ■ Release Lever

The terminals are released with a release lever.

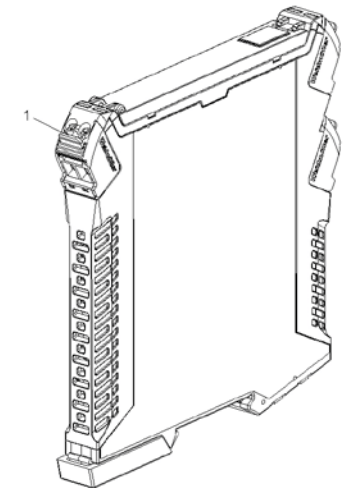

### ■ Open Front Flap

Open the front flap,as shown in the illustration.

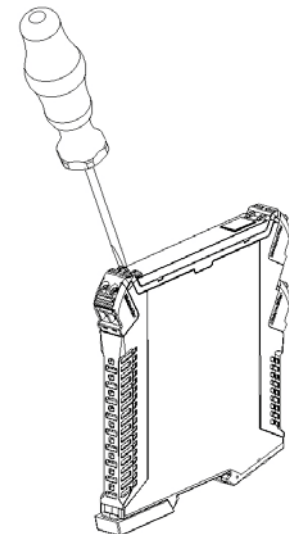

### ■ Maintenance

- (1)Before powering the isolator,make sure the models type is correct according to the design and the application environmental conditions.
- (2)Please choose the power supply with short circuit protection function.
- (3)The electronic products inside temperature should keep stable after they be powered for more than fifteen minutes.
- (4)It is strictly prohibited to test the Insulation capability between any two terminals of the product by a mega-ohmmeter.All of the connecting wires of the isolator must be disconnected, before testing the Insulation of the system,otherwise internal components will be burned out.
- (5)Each product has been tested strictly and the quality is controlled rigidly. If you have any questions regarding this product, contact the nearest distributor or our company technical support hotline directly for assistance.
- (6)In 12 months from delivery date, if the product works improperly in the process of normal usage, we will repair it without charge.

Weidmüller Interface GmbH Klingenbergstr.16  
32758 Detmold  
Germany

Weidmüller Interface (Shanghai) Co.,Ltd.  
25F, BM Intercontinental Business Center, 100 Yutong Road, Shanghai,  
China,200070  
Phone:+86 21 2219-5008  
Fax:+86 21 2219-5009  
www.cnweidmueller.com